

SR022 - BEAM  
2.4MM BEAM ONLY - HAS ID HOLES AT TEAR DROP ENDS OF BEAM

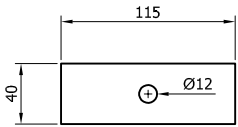

SR152 - WASHER PLATE 115 x 40 x 5 DIA.12

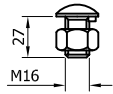

SR200 - SETSCREW 4.6 LIP M16x27 c/w NUT

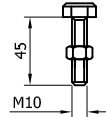

SR124 - SETSCREW M10x45 c/w NUT

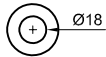

SR300 - M16 WASHER 18φ HOLE



SR301 - M10 WASHER 11φ HOLE

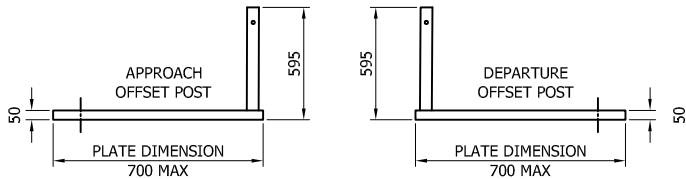

CAN BE FIXED WITH CAST IN ANCHORS, DRILL AND FIX ANCHORS OR PUSHED IN ANCHORS AT 180x180 CENTERS

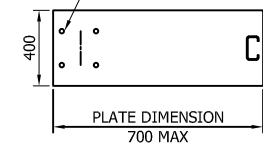

BASEPLATE DRILL & TAPPED FOR LIFTING EYE

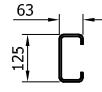
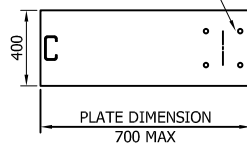

SR040 - TYPE 'A' POST "C" 125 2400mm

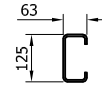

SR035 - TYPE 'A' POST "C" 125 1800mm

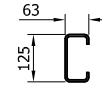

SR034 - TYPE 'A' POST "C" 125 1100mm

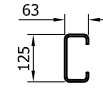

SR036 - TYPE 'A' POST "C" 125 2000mm

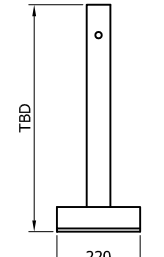
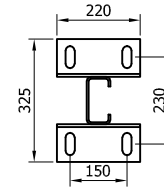

SURFACE MOUNTED - TYPE 'A' C-125 POST

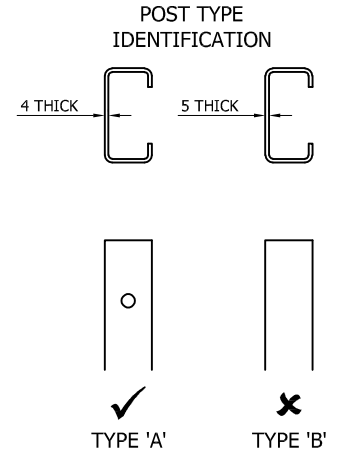

SR100 - A21 REINFORCING RING

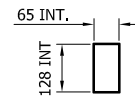

SR080 - C-125 POST SOCKET x 470

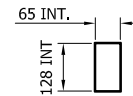

SR081 - C-125 POST SOCKET x 520

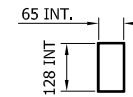

SR083 - C-125 POST SOCKET x 570

REV#	DATE	DETAILS	INITIAL
04	12/02/19	TITLEBLOCK REVISED	H,B
03	10/03/17	DETAILS REVISED	L,L
02	01/02/17	DETAILS REVISED	L,L
1.2	20/05/15	DETAILS REVISED	M,T

# MegaRail em H1 W4 (VI 4)

H1.W4 VEHICLE RESTRAINT SYSTEM COMPONENTS SCHEMATIC

## SAFEROAD®

CONCORD HOUSE,  
BESSEMER WAY, SCUNTHORPE,  
NORTH LINCOLNSHIRE, DN15 8XE  
t: 01724 289119

e: john.cudlipp@saferoad.co.uk

DRAWING NUMBER: <b>H1W4-GA-00</b>	REV#: <b>04</b>
--------------------------------------	-----------------

**BEAM LAP CONNECTION**  
(1 No / 4m BEAM)

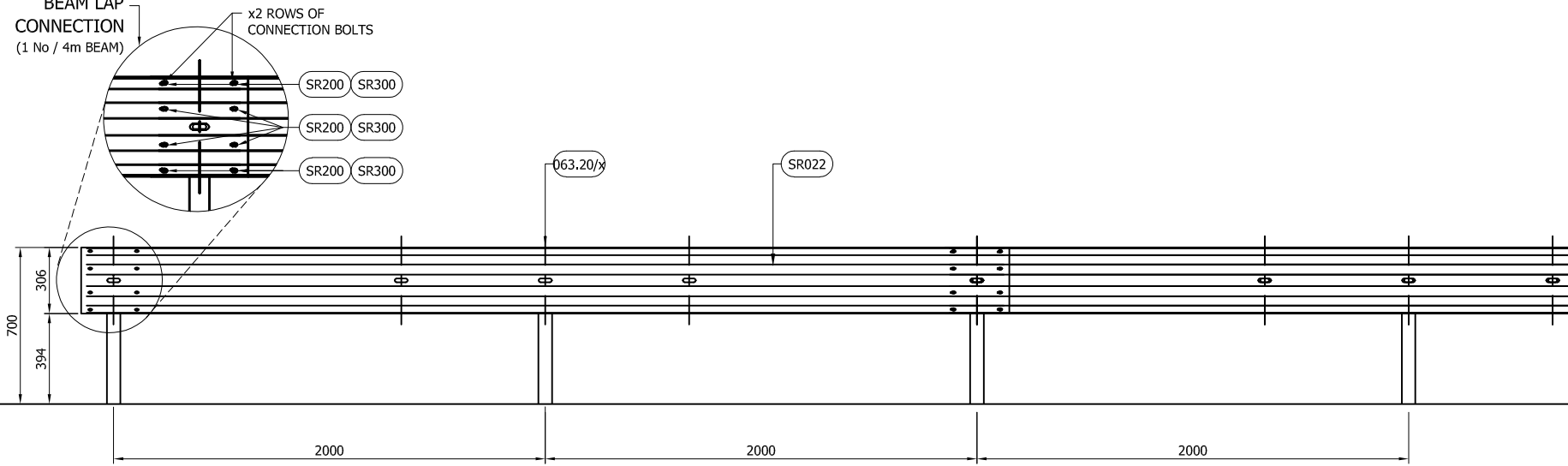

**GENERAL NOTES:**

1. POSTS ARE TO BE INSTALLED WITH THE CLOSED FACE OF THE CHANNEL TOWARDS THE ON-COMING TRAFFIC.
2. FOR OPTIONS ON POST FOUNDATIONS REFER TO DRAWING NUMBER MR-GA-020
3. FOR DEVIATIONS IN SYSTEM POST PITCH REFER TO DRAWING H1W4-GA-40
4. WHEN TYING INTO ADJACENT VRS ONLY ONE WORKING WIDTH DIFFERENCE IS PERMITTED. SEE SYSTEM PROGRESSION DETAILS
5. WHERE A KERB IS PRESENT THE MAXIMUM KERB HEIGHT IS 100mm.
6. FOR MINIMUM LENGTH OF FULL HEIGHT VRS REFER TO SAFEROAD MEGARAIL MANUAL.

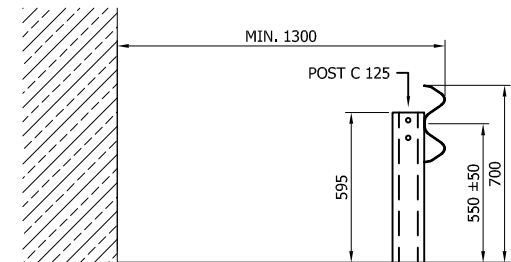
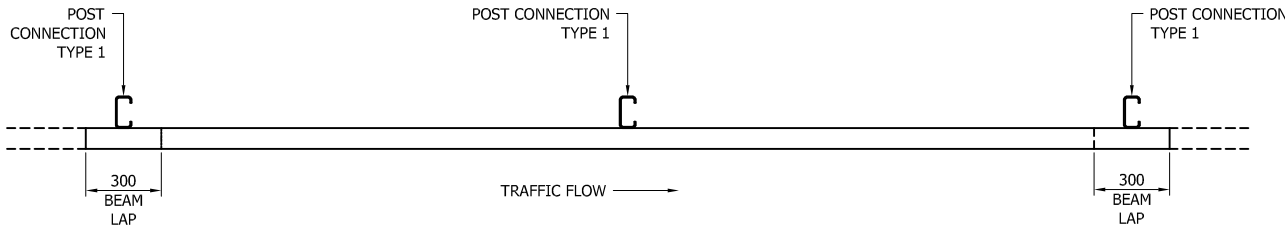

TABLE 'A' - SYSTEM COMPONENT SCHEDULE - QUANTITIES / 4m BEAM		
SAFEROAD UK PART NUMBER	DESCRIPTION	QUANTITY
SR022	BEAM "A" PROFILE	1
SEE TABLE 'B'	POST "C" 125	2
FOR SCHEDULE OF BOLTED CONNECTIONS REFER TO DRAWING NUMBER H1W4-GA-02		

TABLE 'B' - SCHEDULE OF POST REFERENCE NUMBERS AND LENGTHS	
SAFEROAD UK PART NUMBER	POST LENGTH
SR034	1100
SR035	1800
SR036	2000
SR040	2400

04	12/02/19	TITLEBLOCK REVISED	H.B
03	12/02/17	DETAILS REVISED	L.L
02	01/02/17	DETAILS REVISED	L.L
1.2	20/05/15	DETAILS REVISED	M.T
REV#	DATE	DETAILS	INITIAL

## MegaRail em H1 W4 (VI 4)

H1.W4 VEHICLE RESTRAINT SYSTEM  
ASSEMBLY AND SETTING OUT  
ARRANGEMENT

# SAFEROAD®

CONCORD HOUSE,  
BESSEMER WAY, SCUNTHORPE,  
NORTH LINCOLNSHIRE, DN15 8XE  
t: 01724 289119

e: john.cudlipp@saferoad.co.uk

DRAWING NUMBER:

**H1W4-GA-01**

REV#:

**04**

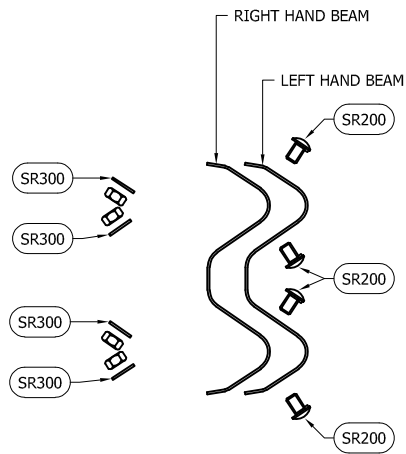

BEAM TO BEAM CONNECTION  
ARRANGEMENT  
(x2 LOCATIONS / BEAM END)

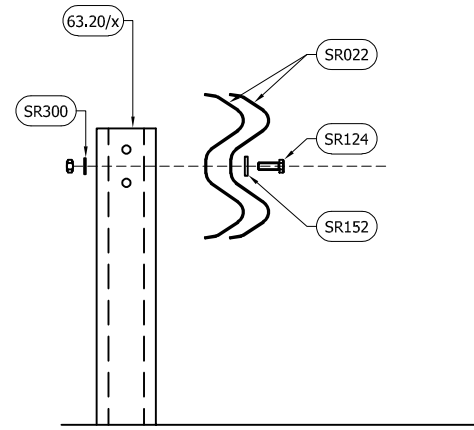

BEAM TO POST  
CONNECTION TYPE 1

GENERAL NOTES:

- NUMBERS IN THE SCHEDULES SUFFIXED (+) DENOTES THE ADDITIONAL QUANTITY OF COMPONENTS REQUIRED FOR EXTREME ENDS OF INDIVIDUAL RUNS OF BARRIER.

BOLTING COMPONENT SCHEDULE - QUANTITIES / BEAM		
SAFEROAD UK PART NUMBER	DESCRIPTION	BEAM TO BEAM CONNECTION
MR180	SETSCREW 4.6 LIP M16x27 c/w NUT	8 (+8)
MR220	WASHER M16 18Ø HOLE	8 (+8)

BOLTING COMPONENT SCHEDULE - QUANTITIES / POST			
SAFEROAD UK PART NUMBER	DESCRIPTION	TYPE 1 CONNECTION	
SR124	SETSCREW 8.8 M10 x 45 c/w NUT	2	
SR152	WASHER PLATE 115 x 40 x 5 DIA. 12	2	
SR301	WASHER M10 12Ø HOLE	2	
		2 (+1)	

\*\* BEAM REFERENCES i.e. LEFT / RIGHT HAND ARE FOR VERGE INSTALLATIONS; FOR CENTRAL RESERVATION INSTALLATIONS THE REFERENCES ARE REVERSED

REV#	DATE	DETAILS	INITIAL
03	12/02/19	TITLEBLOCK REVISED	H,B
02	01/02/17	DETAILS REVISED	L,L
1.2	20/05/15	DETAILS REVISED	M,T

# MegaRail em H1 W4 (VI 4)

H1.W4 VEHICLE RESTRAINT SYSTEM  
BOLTING ARRANGEMENTS

## SAFEROAD®

CONCORD HOUSE,  
BESSEMER WAY, SCUNTHORPE,  
NORTH LINCOLNSHIRE, DN15 8XE  
t: 01724 289119  
e: john.cudlipp@saferoad.co.uk

DRAWING NUMBER: <b>H1W4-GA-02</b>	REV#: <b>03</b>
--------------------------------------	-----------------

GENERAL NOTES:

1. POSTS ARE TO BE INSTALLED WITH THE CLOSED FACE OF THE CHANNEL TOWARDS THE ON-COMING TRAFFIC.

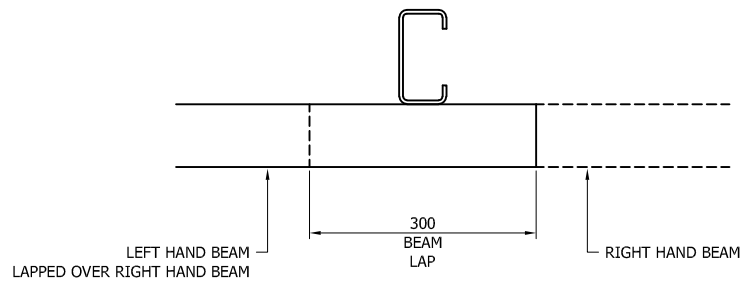
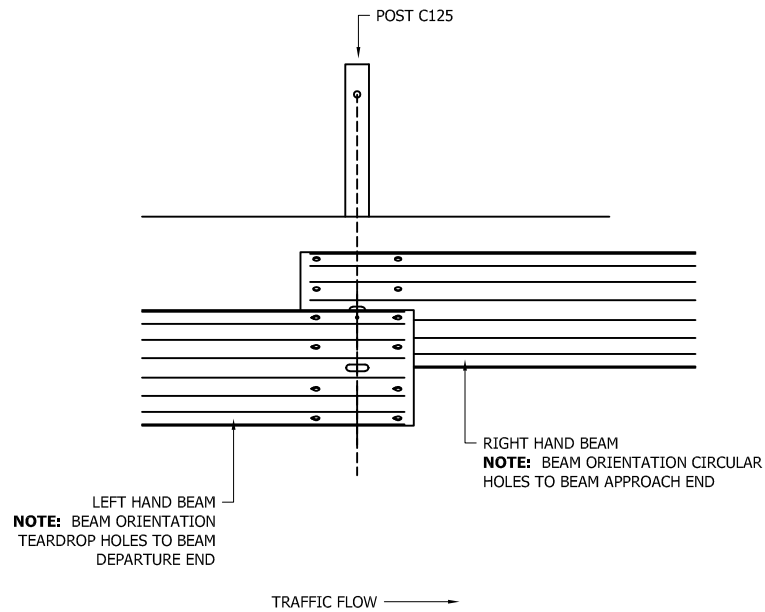

\*\* BEAM REFERENCES i.e. LEFT / RIGHT HAND ARE FOR VERGE INSTALLATIONS; FOR CENTRAL RESERVATION INSTALLATIONS THE REFERENCES ARE REVERSED

REV#	DATE	DETAILS	INITIAL
04	12/02/19	TITLEBLOCK REVISED	H.B
03	01/02/17	DETAILS REVISED	L.L
02	01/02/17	DETAILS REVISED	L.L
1.2	20/05/15	DETAILS REVISED	M.T

## MegaRail em H1 W4 (VI 4)

H1.W4 VEHICLE RESTRAINT SYSTEM.  
BEAM LAPPING DETAIL FOR W4  
MegaRail em SYSTEM

# SAFEROAD®

CONCORD HOUSE,  
BESSEMER WAY, SCUNTHORPE,  
NORTH LINCOLNSHIRE, DN15 8XE  
t: 01724 289119  
e: john.cudlipp@saferoad.co.uk

DRAWING NUMBER:

H1W4-GA-03

REV#:

04

GENERAL NOTES:

1. P.S.B. = POINT FROM WHERE SET-BACK IS MEASURED.
2. POSTS ARE TO BE INSTALLED WITH THE CLOSED FACE OF THE CHANNEL TOWARDS THE ON-COMING TRAFFIC.
3. MINIMUM LENGTH OF FULL HEIGHT VRS IS 44m
4. FOR FURTHER DETAILS OF SYSTEM PROGRESSION SEE MEGA RAIL MANUAL.

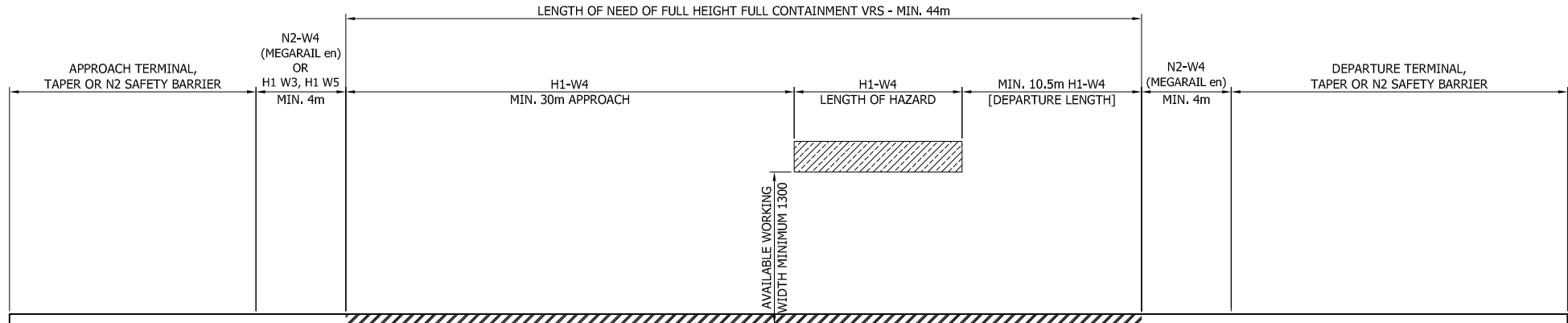

# MegaRail em H1 W4 (VI 4)

VEHICLE RESTRAINT SYSTEM.  
SYSTEM PROGRESSION SCHEMATIC  
FOR H1.W4 PROTECTION TO HAZARD

## SAFEROAD®

CONCORD HOUSE,  
BESSEMER WAY, SCUNTHORPE,  
NORTH LINCOLNSHIRE, DN15 8XE  
t: 01724 289119  
e: john.cudlipp@saferoad.co.uk

REV#	DATE	DETAILS	INITIAL
04	12/02/19	TITLEBLOCK REVISED	H.B
03	10/03/17	WORKING WIDTH REVISED	L.L
02	01/02/17	DETAILS REVISED	L.L
1.2	20/05/15	DETAILS REVISED	M.T

DRAWING NUMBER:

**H1W4-GA-10**

REV#:

**04**

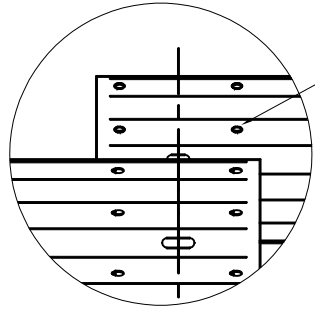
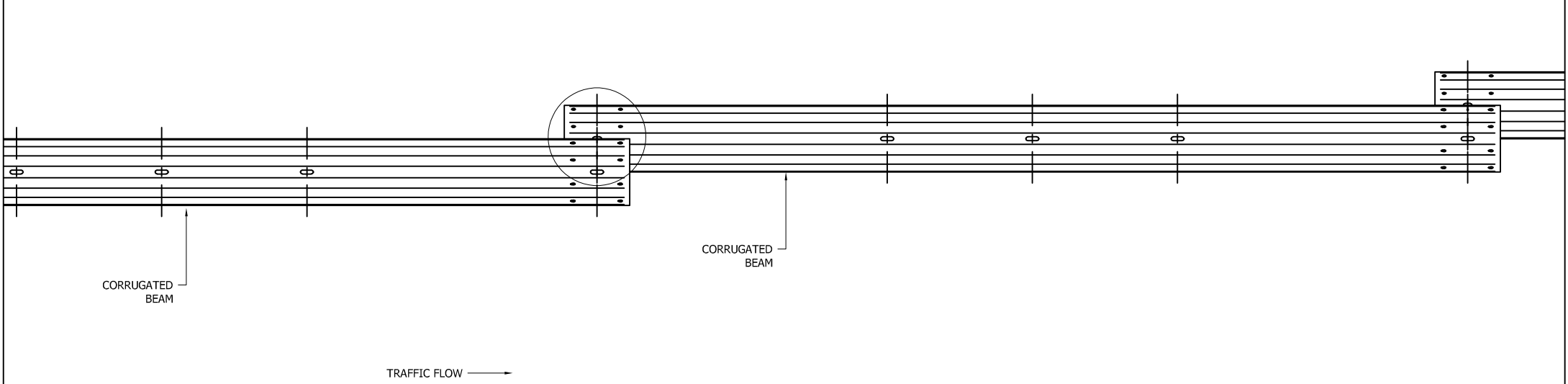
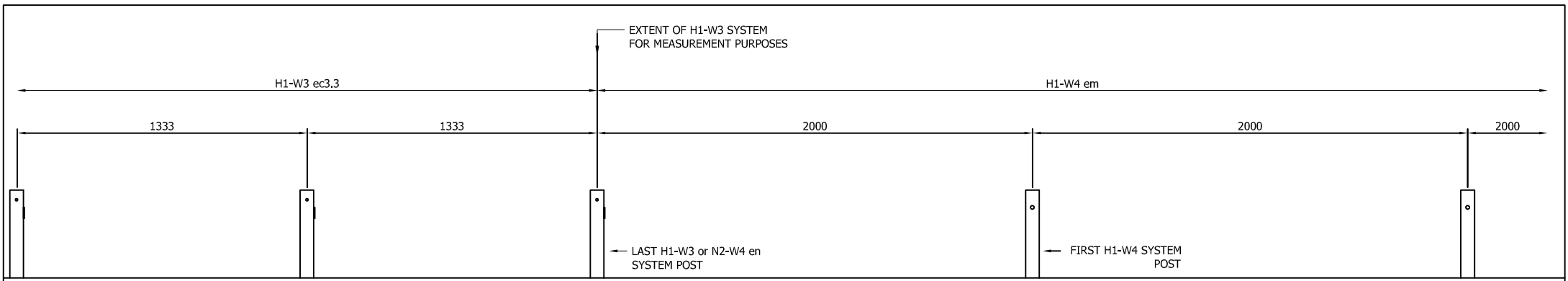

**NOTE:** BEAM ORIENTATION CIRCULAR HOLES TO BEAM APPROACH END

GENERAL NOTES:  
 1. POSTS ARE TO BE INSTALLED WITH THE CLOSED FACE OF THE CHANNEL TOWARDS THE ON-COMING TRAFFIC.

# MegaRail em H1 W4 (VI 4)

H1.W4 VEHICLE RESTRAINT SYSTEM  
 ASSEMBLY & SETTING OUT  
 ARRANGEMENT

**SAFEROAD®**

CONCORD HOUSE,  
 BESSEMER WAY, SCUNTHORPE,  
 NORTH LINCOLNSHIRE, DN15 8XE  
 t: 01724 289119  
 e: john.cudlipp@saferoad.co.uk

\*\* BEAM REFERENCES I.e. LEFT / RIGHT HAND ARE FOR VERGE INSTALLATIONS; FOR CENTRAL RESERVATION INSTALLATIONS THE REFERENCES ARE REVERSED

REVn	DATE	DETAILS	INITIAL
02	12/02/19	TITLEBLOCK REVISED	H.B
01	10/03/17	POST DETAILS REVISED	L.L
00	02/02/17	NEW DRAWING	L.L

DRAWING NUMBER:	REVn:
H1W4-GA-20	02

GENERAL NOTES:

1. IF THE SITE CONDITIONS DO NOT ALLOW A POST TO BE INSTALLED ON THE SYSTEM PITCH DEVIATIONS CAN BE APPLIED. THE OBSTRUCTED POST CAN BE LEFT OUT AND EXTRA POSTS INSTALLED TO SPAN THE OBSTRUCTION. THE NEW POST SPACING MUST NOT EXCEED 3000mm AND MUST NOT BE LESS THAN 500mm. ALTHOUGH IT WOULD BE BENEFICIAL TO USE THE HOLES ALREADY IN THE BEAM IT IS ACCEPTABLE TO DRILL NEW HOLES IN THE DESIRED POSITIONS AND TREAT WITH ZINC RICH PAINT.
2. OFFSET POSTS SHOWN ON DRAWING H1W4-GA-00 CAN BE USED.

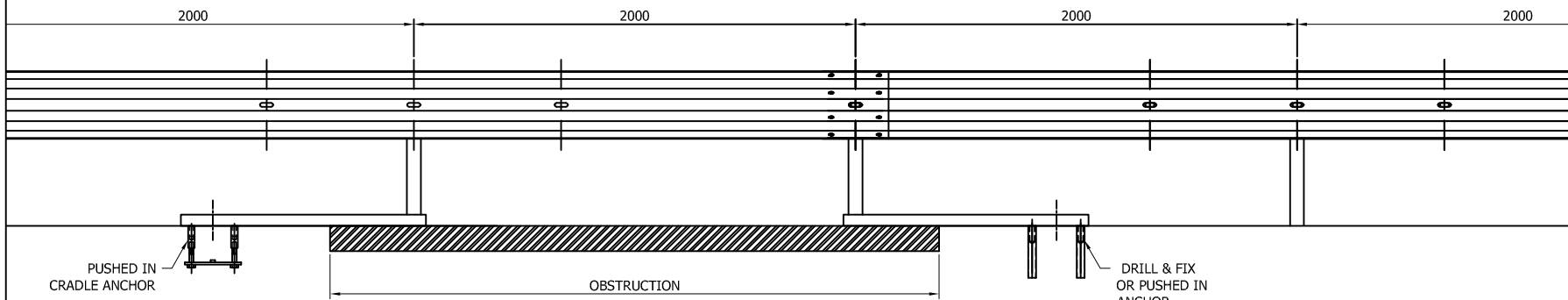
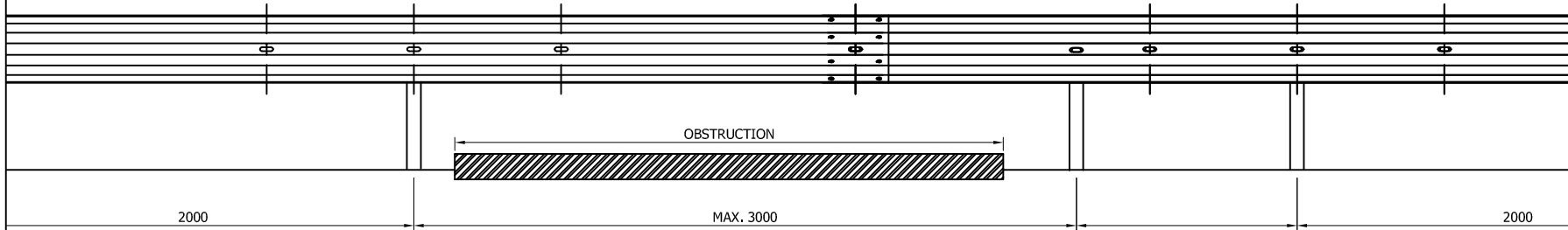
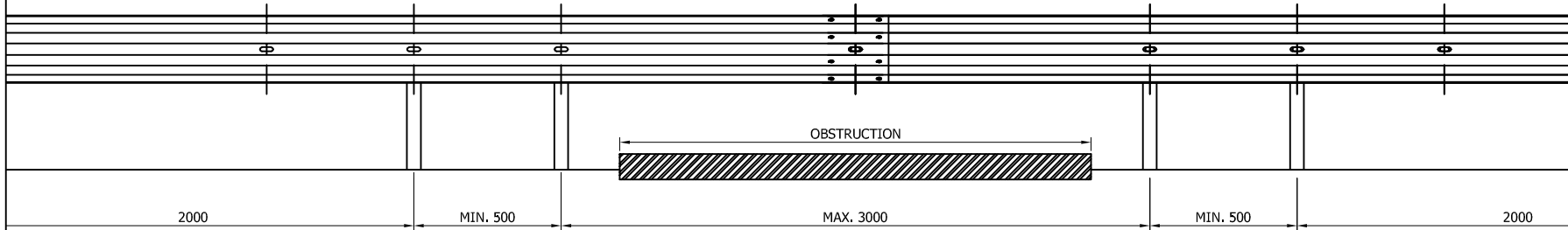

REV#	DATE	DETAILS	INITIAL
02	12/02/19	TITLEBLOCK REVISED	H.B
01	10/03/17	NOTES REVISED	L.L
00	02/02/17	NEW DRAWING	L.L

## MegaRail em H1 W4 (VI 4)

N2.W2 VEHICLE RESTRAINT SYSTEM  
DEVIATION SETTING OUT  
ARRANGEMENT

# SAFEROAD®

CONCORD HOUSE,  
BESSEMER WAY, SCUNTHORPE,  
NORTH LINCOLNSHIRE, DN15 8XE  
t: 01724 289119  
e: john.cudlipp@saferoad.co.uk

DRAWING NUMBER:	REV#:
H1W4-GA-40	02